



Modular Cooking Range Line
thermaline 90 - 800mm Passthrough
Electric Warming Cabinet, 4 doors, GN
conform, 2 Sides(H2)-H=450

ITEM # _____
MODEL # _____
NAME # _____
SIS # _____
AIA # _____



589485 (MC4KCCHOAO)

Passthrough electric
Warming Cabinet, with 4
doors, two-side operated,
GN - H2

Short Form Specification

Item No. _____

800 mm wide passthrough warming cabinet with 4 doors. Internal frame for heavy duty sturdiness in stainless steel. Flat surface construction, easily cleanable. Temperature in the cabinet can be set through thermostat, up to a maximum of 110 ° C. Cabinet storage space accepts GN 1/1 containers. IPX5 water resistant certification. Configuration: Two-side operated freestanding base, hygienic class H2.

Main Features

- All major components may be easily accessed from the front.
- THERMODUL connection system creates a seamless work top when units are connected to each other thus avoiding soil penetrating vital components and facilitating the removal of units in case of replacement or service.
- Unit constructed according to DIN 18860_2 with 70 mm recessed plinth.
- Temperature in the cupboard can be set through a thermostat to suit different requirements. The maximum temperature is 110°C.
- Unit can be installed below modular top appliances, designed to keep plates warm.

Construction

- IPX5 water resistance certification.
- 2 mm top in 1.4301 (AISI 304).
- Flat surface construction with minimal hidden areas to easily clean all surfaces
- Storage space in the base of the appliance accepts GN1/1 containers.
- Internal frame for heavy duty sturdiness in stainless steel.

APPROVAL: _____



Experience the Excellence
www.electroluxprofessional.com



Electrolux
PROFESSIONAL

Modular Cooking Range Line
thermaline 90 - 800mm Passthrough Electric
Warming Cabinet, 4 doors, GN conform, 2
Sides(H2)-H=450

Front

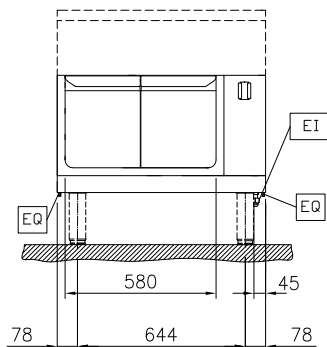

Side

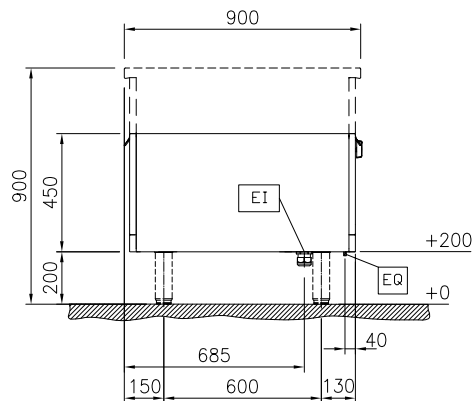

EI = Electrical inlet (power)

Top

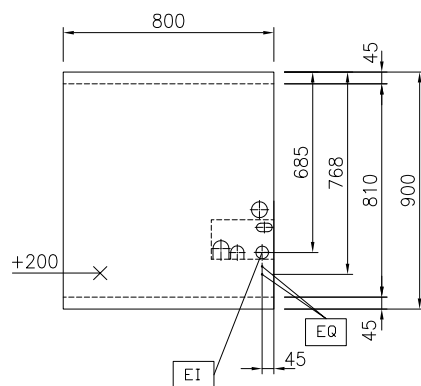

Key Information:

| | |
|--------------------------------------|-----------|
| External dimensions, Width: | |
| 589485 (MC4KCCHAO) | 800 mm |
| External dimensions, Depth: | 900 mm |
| External dimensions, Height: | 450 mm |
| Cupboard Cavity Dimensions (width): | 580 mm |
| Cupboard Cavity Dimensions (height): | 330 mm |
| Cupboard Cavity Dimensions (depth): | 810 mm |
| Cabinet temperature range: | 30-110 °C |
| Net weight: | 34 kg |

Sustainability

| | |
|----------------------|--------|
| Current consumption: | 5 Amps |
|----------------------|--------|



Modular Cooking Range Line
thermaline 90 - 800mm Passthrough Electric Warming Cabinet, 4 doors,
GN conform, 2 Sides(H2)-H=450
The company reserves the right to make modifications to the products
without prior notice. All information correct at time of printing.

2025.12.12

Optional Accessories

- Stainless steel side panel, 900x700mm, freestanding PNC 912512 ☐
- Stainless steel front kicking strip, 800mm width PNC 912634 ☐
- Stainless steel side kicking strip left and right, freestanding, 900mm width PNC 912657 ☐
- Stainless steel plinth, freestanding, 800mm width PNC 912958 ☐
- Perforated shelf for warming cabinets and cupboard bases (two-side operated for TL90) PNC 913237 ☐
- Energy optimizer kit 14A - factory fitted PNC 913244 ☐
- Side reinforced panel only in combination with side shelf, for freestanding units PNC 913260 ☐
- Shelf fixation for TL90 two-side operated PNC 913282 ☐
- Stainless steel dividing panel, 900x700mm, (it should only be used between Electrolux Professional thermaline Modular 90 and thermaline C90) PNC 913672 ☐
- Stainless steel side panel, 900x700mm, flush-fitting (it should only be used against the wall, against a niche and in between Electrolux Professional thermaline and ProThermetic appliances and external appliances - provided that these have at least the same dimensions) PNC 913688 ☐